



LG Code **Zero** SVC Manual

Caution : Please read the safety cautions of this booklet
before checking the product.

Buyer Model Name : A9*****

Factory Model Name : VS97*****

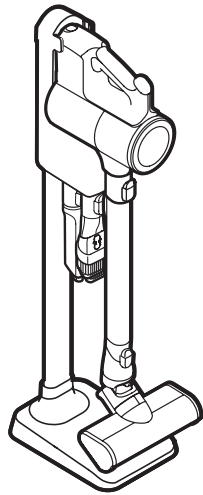

P.No MFL68043134

July, 2017
Printed in Korea

Content

■ Product features	3
■ Parts and names.....	4
■ Cleaner features.....	5
■ Check these out before use.....	6
■ Cautions for general usage	7~12
■ Technical descriptions of parts	13
■ How to use	14~19
■ Disassembly, assembly and repairing of main parts	20~26
■ Cautions and what to check for repairing	27
■ Circuit diagram	28~31
■ Symptoms of malfunctions and measures	32~33
■ Cleaning functions and error modes	34
■ Exploded diagram	35~41

Product features

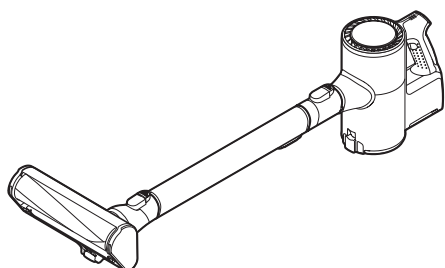

Item/Model	VS97*****
Dimensions	260 mm(W) X 270 mm(L) X 1120 mm(H)
Weight	2.7 kg
Power consumption:	400 W (Maximum of 450 W)/ 250 W/ 80 W (Turbo/Power/ Standard)
Suction power	140 W(In Turbo mode) 1)
Battery	DC 25.55 V
Battery life (After full charge, In handy mode)	Approx. 6 minutes in Turbo
	Approx. 9 minutes in Power
	Approx. 40 minutes in Standard



Item	Charger (Adaptor)
Input	100 - 240 V~ 50/60 Hz, 0.8 A
Output	DC 29.4 V 1.0 A

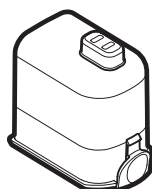

Item/Model	Battery
Type	Rechargeable Lithium Battery
Rated	DC 25.55 V , 1900 mAh
Number of battery cells	7 ea.
Manufactured by	LG Chem (Battery pack manufactured by TWS TECHNOLOGY (GUANGZHOU) LIMITED)

1) The suction power measurement standard is an average value measured by an independent testing institute by borrowing and some changes, and individual measured values may differ.

Parts and names

Standing type

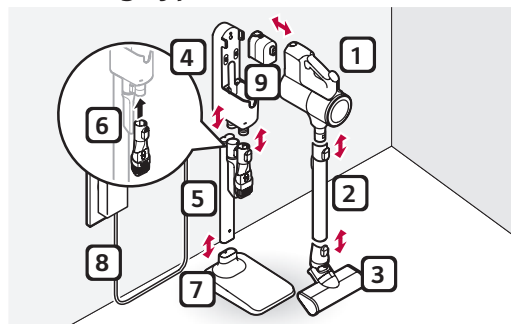

- ① Product body
- ② Extension pipe
- ③ Charging station
- ④ Adapter
- ⑤ Charging station pipe
- ⑥ 2-in-1, blade-shaped inlet holder
- ⑦ Charging station support
- ⑧ Adaptor
- ⑨ Battery

Wall type

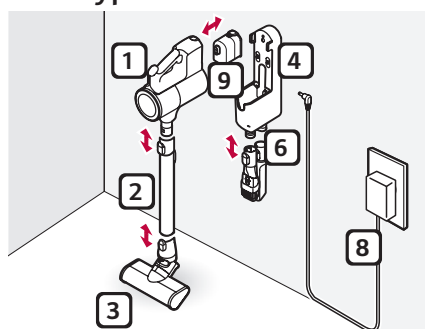

Body parts

- Parts may vary depending on the specific model that you purchased.



Battery

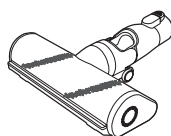

Inlet port for carpet

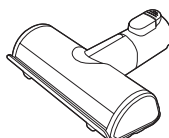

Inlet port for bedclothing

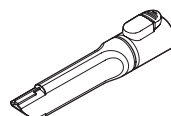

Blade shaped inlet port

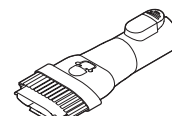

2 in 1 inlet port



Wall anchoring block

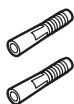

Screw anchor (2)



Double sided tape (2)



Mattress Tool



Hard Dirty Tool

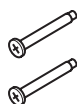

Anchoring screw for wall type (Φ 3.5 mm, length 90 mm)

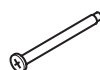

Anchoring screw for standing type (Φ 3.5 mm, length 50 mm)

※ There may be local gradation thanks to the eco-friendly design technology instead of the traditional coating method that generates harmful substances. Rest assured that the performance of the product will not be affected at all by the gradation.

Cleaner features

1. **The product boasts of powerful suction that can be adjusted per purpose and site.**
The integrated inverter motor ensures consistent suction and you can adjust the suction strength depending on where you are cleaning.
2. **Anti tangle power nozzle**
For cleaning ultrafine particles
3. **Dual lithium batteries**
Two long-life dual lithium batteries eliminates the need for charging in the middle of cleaning. Each battery lasts about 40 minutes in the Standard mode and the two give you approximately 80 minutes of cleaning.
4. **Independent wall mounting charging station**
Independent wall mounting charging station eliminates the need to securing the space for the charging station.
5. **Wireless convenience**
The product can be used remotely so that the inconvenience from cables can be eliminated.

Check these out before use

What to be aware of about using the product

- Make sure that the dust bin lid is on prior to using the product. Otherwise, suction strength will deteriorate and cleaning will not be satisfactory.
- Support the bottom of the product when cleaning an elevated surface.
- While leaving the product unattended or not using the product for extended period, make sure to properly put it in the charging station or lie it on a floor. Otherwise, the product may fall and get damaged or cause injury to people.
- Make sure that the exhaust filter is properly assembled before using the product.
- Environmental conditions such as temperature and humidity may cause static on the product. Please contact the customer service of LG Electronics if a same issue persists.
- Any foreign object on the inlet port or extension pipe will prevent the product from proper operation. Make sure to remove any foreign object such as a sock or stocking before using the product.
- Battery life will be shortened after using the product for extended period thanks to its nature.
- When battery is about to get fully discharged, the last block on the battery indicator starts to flash and the product will power off after a while. Fully charge the battery in this case.
- Please use the product at room temperature as the battery life will deteriorate severely if used at temperatures lower than 5°C or higher than 38°C for an extended period of time.

Cautions for general usage

The following cautions intend to protect you from unexpected risk or property loss by ensuring safe and correct usage of the product.

Cautions are categorized into 'Warning' and 'Care', which mean:

⚠ The pictogram aims to remind you of matters and usage that may pose risks to the user.
Make sure to carefully read the item with this symbol and comply with it to prevent any potential risk.

⚠ Warning - Failure to comply with this may cause serious damage, injury or even death to the user.

⚠ Care - Failure to comply with this may cause damage to the product or moderate injury to the user.

⚠ Warning

Installation

Do not install the product where it is exposed to water, rainfall or severe moisture.

- Such locations make the product vulnerable to fire while charging the battery.
- Please install the product in a well-ventilated place.

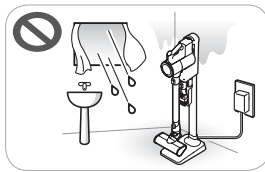

Please put the charging station on an even surface.

- Otherwise, the product may fall and get damaged or cause injury.

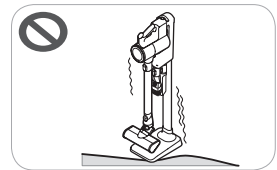

Make sure to avoid places with leakage of flammable gas, industrial oil or metallic dust.

- It may cause malfunction of the product or damage it.

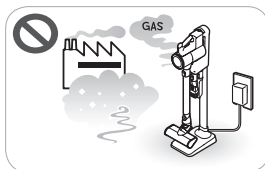

If you intend to use the charging station as "wall type", make sure to anchoring it on the wall with a screw for wall type.

- It may damage the product and/or injure people.

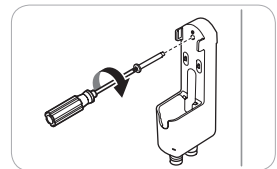

If you intend to use the charging station as "standing", make sure to anchoring it on the wall with a screw for standing type.

- Otherwise, the station or product may slant and get damaged or cause property damage or injury.

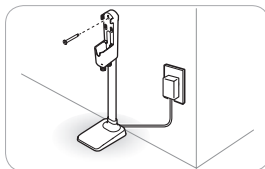

Never install the charging station on the wall if there is any piping (power, water) or power cable behind the walls.

- There is risk of injury from electric shock or fire.

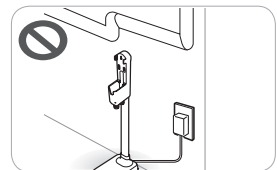

Cautions for general usage

Power requirements

This product is to be used AC 220V only. Make sure to check the power specifications of the place to use the product.

- Wrong specifications will result in electric shock or damage the product upon short-circuiting.

Do not apply excessive force on power cord to bend it, or put it under heavy object to cause damage.

- The power cord may get damaged and cause electric shock or injury.

Please refrain from using multiple power appliances in one power strip or power socket and make sure to use the power socket with capacity of +15A.

- Such usage may result in fire due to abnormal overheating of the socket.
- Or it may activate the circuit breaker and you will lose power.

Never get in contact with the power cord and plug with a wet hand.

- Otherwise, you may get injured or suffer electric shock.

Please clear any dust or water from the power cord and plug with a dry cloth.

- It may cause electric shock, short circuit or fire.

When unplugging the power cord, never pull the cord itself and always hold the power plug.

- Pulling the cord damages it and causes electric shock or fire.

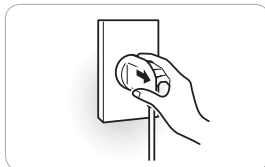
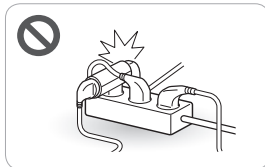
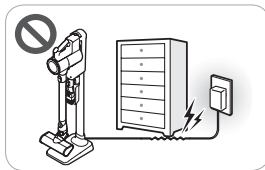
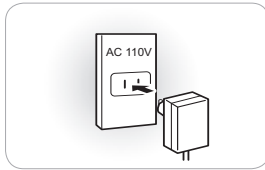

Please stop using the product and contact the customer service of LG Electronics upon finding that the power cord or power plug is damaged or that the holes of the power socket are loose.

- It may cause electric shock or fire.

Make sure to unplug the power cord when cleaning or maintaining the charging station.

- Otherwise, you may get injured or suffer electric shock.

Make sure to unplug the power cord when the product is not to be used for extended period of time.

- Otherwise, you may suffer electric shock, short circuit or fire.

Make sure to organize the power cord of the charging station while using or cleaning the product.

- Otherwise, the cord may get tangled on the product's body to cause malfunction of the product, electric shock or injury when it gets disconnected/broken.

Make sure to avoid touching the pins of the power plug with your finger(s) when unplugging the power cord.

- It may cause electric shock or fire.

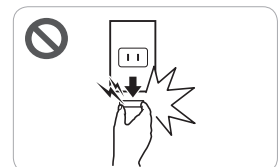
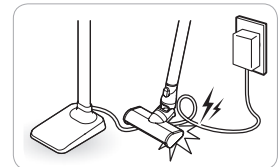
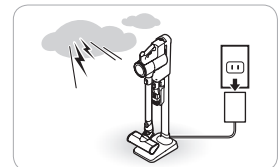
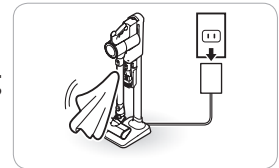
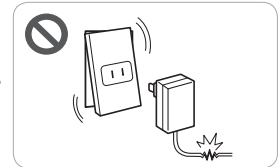

Cautions for general usage

Proper usage

Make sure that no child is allowed to use the product.

- The product weighs too much for a child to handle properly.



Make sure that no hand, foot, hair or cloth gets stuck in the rotating brush or wheel while using or cleaning the product.

- It may damage the product and/or injure people.

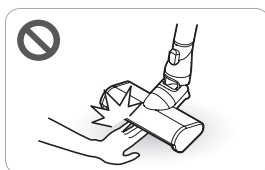

No one other than a qualified technician/service engineer from LG Electronics may disassemble, repair or modify the product.

- It may cause electric shock, injury or fire.

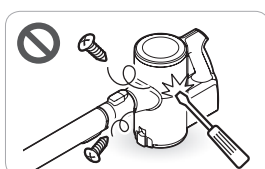

Never use the battery and the charging station for other appliances than the product.

- It may cause malfunctioning or fire.

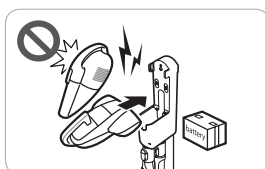

Do not use the battery from other appliances with the product.

- It may cause malfunctioning or fire.

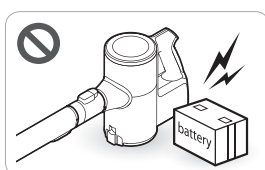

Do not arbitrarily disassemble, remove or short circuit the battery.

- It may cause electric shock, injury or fire.

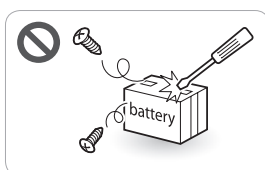

Do not apply heat or shock to the battery.

- It may cause electric shock, injury or fire.

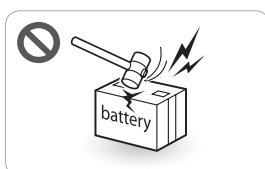

Never insert a sharp metallic object such as an awl in the hole or gap on the product or the charging station.

- Otherwise, you may get injured or suffer electric shock.

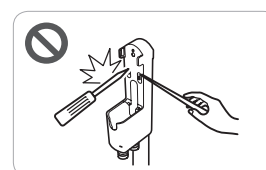

Make sure that no water, beverage or detergent may get inside the product or the charging station.

- Otherwise, you may get injured or suffer electric shock.

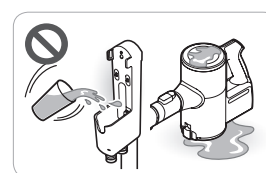

Do not apply or spray flammable substance (gasoline or thinner) or surface active agent (detergent or bath soap) on the product.

- It may cause malfunctioning or fire.

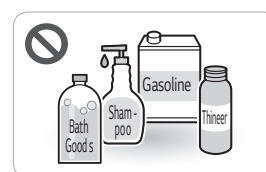

If there is gas leakage (propane or urban gas), make sure to ventilate the area first without getting into contact with the product or its power plug.

- Otherwise, there will be sparks which cause explosion, fire or injury.

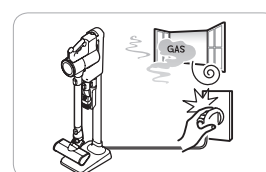

Do not use or store a heating device or flammable substance (ether, benzene, alcohol, chemicals, combustible spray, insecticide, air freshener or cosmetics) in close proximity to the product.

- It may cause malfunctioning or fire.

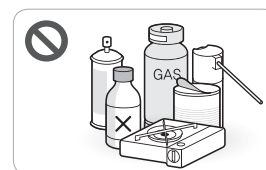

Cautions for general usage

Do not clean liquid (such as water, beverage), metallic object (such as blade, pins), flammable substance, surface active agent, glass shards with the product.

- It may cause malfunctioning or fire.
- In the event that any liquid, metallic object, glass shard or spark got into the inside of the product, immediately power off the product and contact the customer service of LG Electronics.

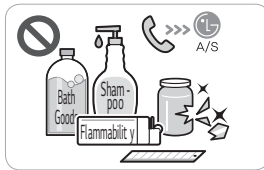

Do not use the product with the exhaust or inlet port blocked.

- It causes the product to over-heat and will result malfunctions or fire.

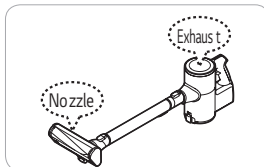

In the event that there is smoke from the product while it is charged, immediately unplug the power cord and contact the customer service of LG Electronics.

- It may cause electric shock or fire.

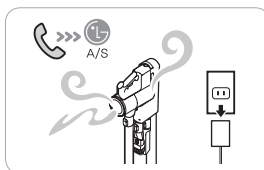

Do not expose the product, and battery in particular, to heat, heating device or direct sunlight

- it may cause electric shock, explosion or fire.

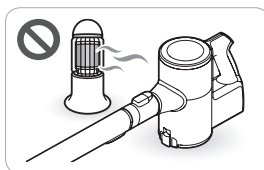

Do not keep the product or its battery inside a vehicle which is exposed to direct sunlight.

- It may cause fire or explosion.

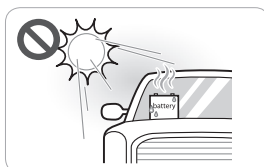

In the event that some kind of liquid come from the battery, make sure that it does not get into contact with the skin or the eye.

- It may cause fire or severely damage the eye.
- If the liquid from the battery got into contact with a part of skin, immediately wash off with ample amount of water and seek medical advice.

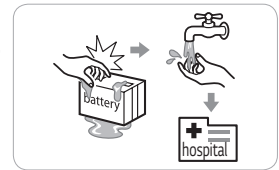

Do not wash the inlet port with water or detergent.

- As the inlet port has a motor inside, you may suffer electric shock or fire.



Always use the provided charging station only to charge the product and its battery.

- Any charging device other than the provided station will cause damage the battery and result in electric shock, explosion or fire.

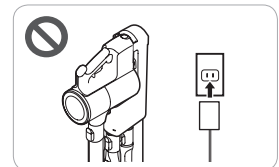

Never allow any water, beverage or detergent to get inside of the battery.

- it may cause electric shock, explosion or fire.

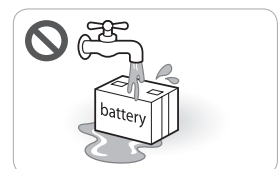

Do not touch the charging terminals on the product and the charging station, or insert an electrified object inside the product or the station.

- Otherwise, you may get injured or suffer electric shock.



Cautions for general usage

Always keep the product on the charging station when it is not in use.

- Otherwise, the product may fall and get damaged or cause injury.

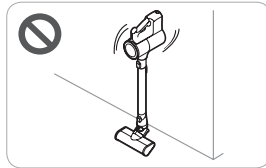

In the event that the earth leakage breaker gets activated when the product is put on the charging station, immediately remove the product from the station and contact the customer service of LG Electronics.

- It may cause electric shock or fire.

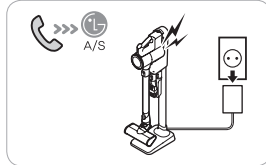

Do not wash the dust bin with water.

- The water will get into the motor and cause electric shock or fire.



Do not clean fine dust such as cement with the product.

- It may cause malfunctioning or fire.

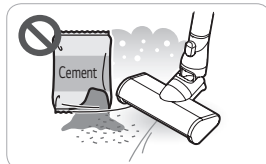

Make sure that no child may play with the product, the charging station or the battery.

- It may damage the product and/or injure people.
- Especially when they put the product or batter into the mouth, it will cause electric shock or injury to them or damage the product or battery.



Disposal

Discard packing materials(plastic vinyl, styrofoam) so that no child may get into contact with them.

- Such materials may cause suffocation.



When disposing of the product, make sure to remove the battery from the product's body.

- It may cause fire or explosion.

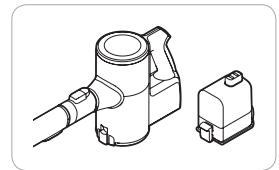

Cautions for general usage

⚠ Care

Proper usage

Do not apply shock to the product or drop it from height.

- It may damage the product and/or injure people.

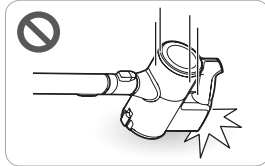

Make sure that the product never falls.

- It may cause injury or damage the product.

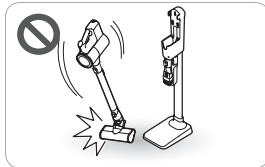

Make sure that the product has a filter installed each time prior to using the product.

- It may cause the product to malfunction.

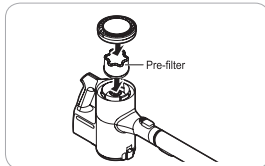

Make sure to clear liquid such as water or oil or excrement of a pet from the floor before using the product.

- Such substances will further contaminate the floor.



Do not clean the product with volatile or organic solvent (thinner or acetone).

- It damages the product.
- Always use a soft cloth to clean the product.



Make sure to avoid running into a person or a pet while using the product.

- It may cause injury.



Do not kick the product with a foot.

- It may cause the product to malfunction.



Do not put any object other than the product, especially a metallic or magnetic object, on the charging station.

- Such an object may damage the product or cause electric shocks.

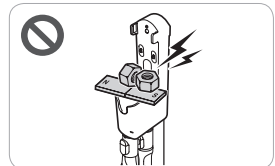

Do not clean the same spot repeatedly for extended time.

- Vibration from the inlet port may damage the floor or the carpet.

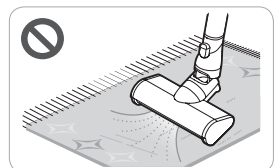

Make sure that your finger does not get stuck when assembling the product or the charging station.

- Your finger may get injured.



Do not let a child or a pet hang onto the charging station.

- It may cause injury or damage the product.



Do not put double-sided tape on the wallpaper directly since it may get torn by external force.

- Anchor the charging station with the wall anchoring screw to prevent tearing of the wallpaper.

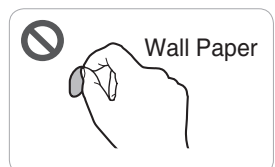

Do not apply force on the dust net.

- The dust net may get deformed.



Technical descriptions of parts

Item \ Model	VS97*****
Category	Integrated motor
Power	DC 25.55V
Power consumption	400 W (MAX : 450 W)
R. P. M	115000 R.P.M
Lifecycle	More than 205 hours

How to use

Note about using the product

What to be aware of about using the product

- Make sure that the dust bin lid is on prior to using the product. Otherwise, suction strength will deteriorate and cleaning will not be satisfactory.
- Support the bottom of the product when cleaning an elevated surface.
- While leaving the product unattended or not using the product for extended period, make sure to properly put it in the charging station or lie it on a floor. Otherwise, the product may fall and get damaged or cause injury to people.
- Make sure that the exhaust filter is properly assembled before using the product.
- Environmental conditions such as temperature and humidity may cause static on the product. Please contact the customer service of LG Electronics if a same issue persists.
- Any foreign object on the inlet port or extension pipe will prevent the product from proper operation. Make sure to remove any foreign object such as a sock or stocking before using the product.
- Battery life will be shortened after using the product for extended period thanks to its nature.
- When battery is about to get fully discharged, the last block on the battery indicator starts to flash and the product will power off after a while. Fully charge the battery in this case.
- Please use the product at room temperature as the battery life will deteriorate severely if used at temperatures lower than 5°C or higher than 38°C for an extended period of time.

Using the product

- 1 Assemble the body, extension pipe, inlet, and battery in that sequence.

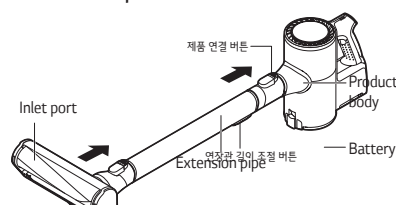

- 2 Press the button on the extension pipe to adjust its length.
 - The pipe has 4 lengths.

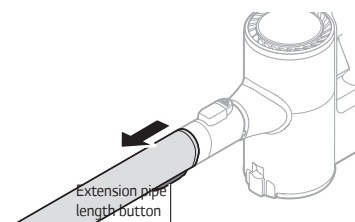

- 3 Attach the inlet to the body or extension pipe.

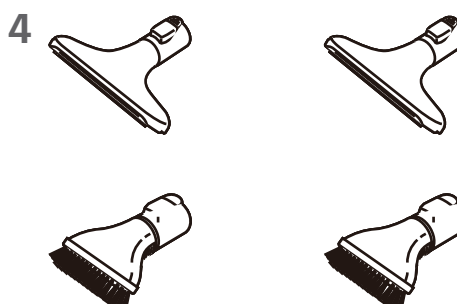
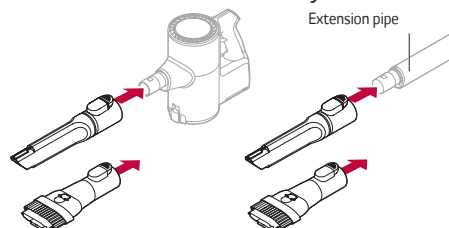

⚠ Care

- Using the product for a long time with the accessory inlet port attached may overburden the motor.
- Using the accessory inlet port on a TV, monitor or LCD display may leave a scratch on the surface.
- Apply caution to avoid getting your finger stuck in a gap.
- Any foreign object sucked during cleaning in the inlet will stop the inlet in order to prevent damage to the body or inlet. Remove the object before resuming cleaning.

How to use

Charging the product

- 1 Put the product in the charging station.
 - The battery indicator starts to flash and charging will start in 3 steps.

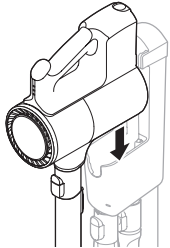

- 2 The battery indicator starts to flash and charging will start.
 - The indicator will stay on when the battery is fully charged.

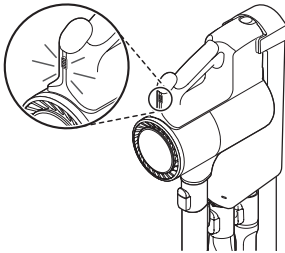

⚠ Care

- Make sure to fully fit the product in the station. Otherwise, the product may fall and get damaged.

Please note

- The batteries need to be fully charged for the first usage after purchase as they are not charged.
- The battery indicator will flash if the product is fully charged, removed from the station, and charged again soon. The flashing stops soon, and the indicator stays on.

Charging auxiliary battery

- 1 Hold the product and pull the battery by pressing both ends of the battery.

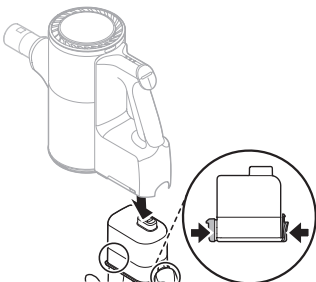

- 2 Put the battery in the auxiliary charging station.

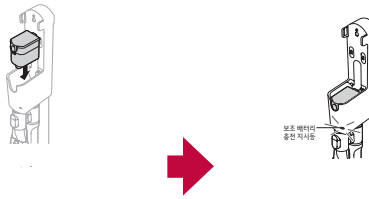

Charging indicator of _____
the auxiliary battery

Please note

- Make sure that the power adapter is connected to both the charging station and the power outlet
- While the main battery is charged on the charging station, the auxiliary battery will start to be charged after the main battery is fully charged.
- The auxiliary battery indicator flashes when charging starts.
- The indicator will stay on when the auxiliary battery is fully charged.

Power / Strength button

You can adjust the suction strength with the strength button on the body. The product does not switch from standard mode to turbo mode immediately.

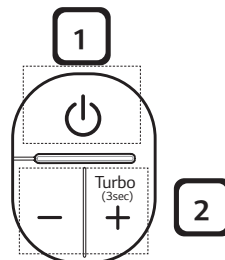

① Power on/off button

② Mode button

- Press "+" once to enable Power mode.
- Press and hold "+" for more than 3 seconds to enable Turbo mode.
- Press "-" to switch from Turbo to Power, or from Power to Standard.

Please note

Battery life per mode (After full charge)

- Standard: 40 minutes
- Power: 9 minutes
- Turbo: 6 minutes

How to use

Using inlet port

- Please note that the following are applied to the corresponding models:
- The inlet can be attached to the product body or the extension pipe.
- Use a different mode if the inlet gets stuck on the floor, carpet, or bedclothes or if you need a more powerful mode.

Care

- Do not use the product for purposes other than cleaning.

Floor inlet

- It is suitable for cleaning general floors.

Carpet inlet

- It is suitable for cleaning carpets or rugs.
- It can be used to clean floors but may generate some noise; thus, we recommend using a suitable inlet.

Care

- Do not use this inlet as play mat for children.
- Any foreign object sucked during cleaning in the inlet will stop the inlet in order to prevent damage to the body or inlet. Remove the object before resuming cleaning.

Bedclothes inlet

- This inlet lets you clean bedclothes more easily.
- Attach it to the extension pipe.

Blade shaped inlet port

It is suitable for cleaning dust in a corner or a narrow space.

Mattress inlet

- Use this tool when cleaning mattress.

Hard Dirty inlet

- Use this tool when cleaning all dust stuck on the floor.

2 in 1 inlet port

The accessory inlet port is helpful for cleaning a corner or small gap.

Basic

For cleaning flat surfaces such as a sofa or mattress.

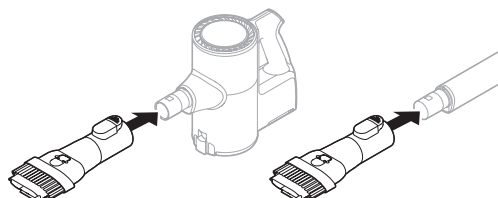

Brush type

For cleaning delicate surfaces such as a frame or furniture.

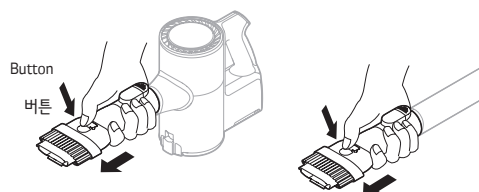

Care

- Using the product for a long time with the accessory inlet port attached may overburden the motor.
- Using the accessory inlet port on a TV, monitor or LCD display may leave a scratch on the surface.
- Avoid getting your finger stuck in a gap.
- Any foreign object sucked during cleaning in the inlet will stop the inlet in order to prevent damage to the body or inlet. Remove the object before resuming cleaning.

How to use

Cleaning the dust bin

- 1 Remove the battery from the product before cleaning.
- 2 Please move close to a wastebasket or where dust/foreign object can be emptied easily.
- 3 Press the dust bin button downward to open it.
 - Empty the bin.
 - Be careful as dust/foreign object may spill when you open the dust bin.

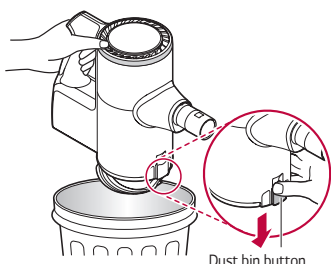

- 4 Insert the blade-shaped inlet into the large dust separation device and turn counterclockwise to remove it.

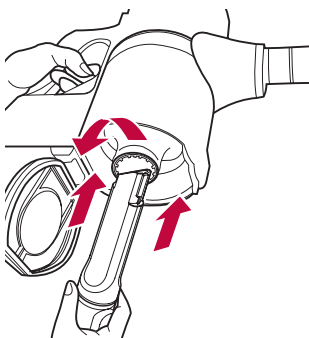

- 5 Wash the dust separation device with running water.
 - Be sure to dry the device completely before using it.

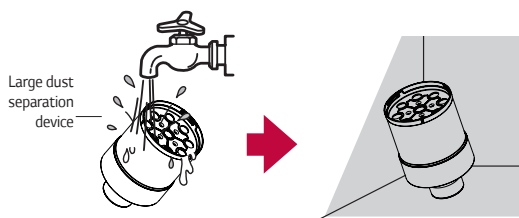

- 6 Remove the dust separation device and use the 2-in-1 inlet port to clear the dust inside the dust bin.

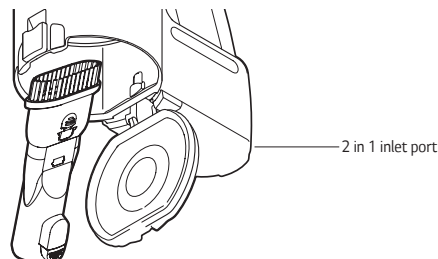

⚠ Warning

- Never wash the product's body with water. Water may reach the motor and cause electric shock or fire.
- Do not apply force or shock on the dust net of the dust separation device. The net may get damaged.
- Use the product only after cleaning the dust separation device and assembling it back on the product. Operating the product without assembling the device back on the product will damage the product.

Cleaning filters

The pre-filter and exhaust filter need to be cleaned at least monthly to maintain the cleaning performance of the product.

- 1 Turn the exhaust filter counterclockwise to remove it and take out the pre-filter.

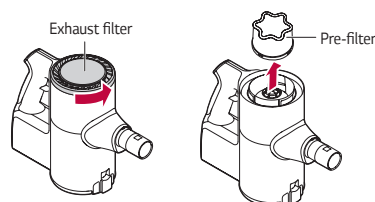

- 2 Use the 2-in-1 inlet to clear dust from the motor part.

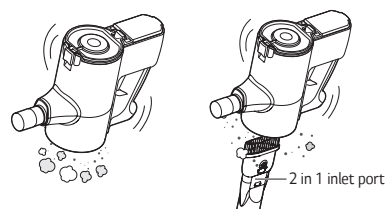

How to use

- 3 Brush dust off from the exhaust filter.
- Make sure to clean the exhaust filter every month to ensure optimal cleaning performance.

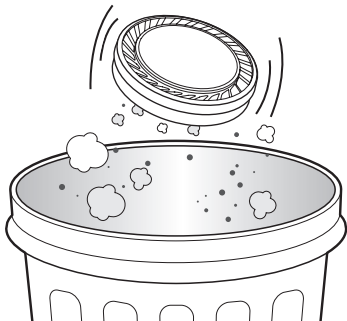

⚠ Care

- Do not wash the exhaust filter with water.
- 4 Clean the pre-filter by brushing dust off or with running water.
- Washing the pre-filter with water and not completely drying, it may cause it to smell. Make sure to use it after drying it completely.
 - The more often the filters are cleaned, the more optimal the suction power will be.
 - Filters are consumables.
 - Please purchase more filters at our authorized service center.

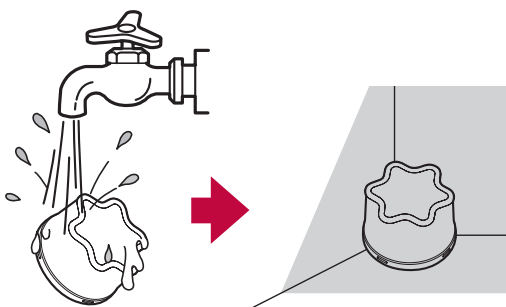

- 5 Attach the pre-filter first followed by the exhaust filter to fit the white circle and turn it clockwise.

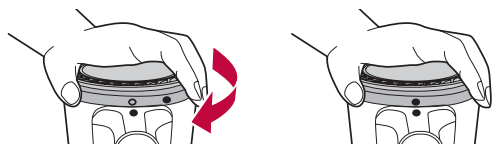

⚠ Warning

- Never wash the product's body with water. Water may reach the motor and cause electric shock or fire.
- Make sure that no foreign object reaches the motor. It damages the product or causes explosion or fire.
- Do not insert a finger or a sharp object where the motor is. It damages the product or cause injury or electric shock.

⚠ Care

- Make sure to reattach the exhaust filter and pre-filter back to the product after washing them. Using the product with these filters will cause dust reach the motor inside the product and cause malfunction.

Please note

- Too much dust will deteriorate suction power, thus, we recommend cleaning the filters before and after cleaning.

※ Removing foreign object from inside the product

In order to maintain product performance, be sure to remove any foreign object and dust from inside of the product (body, extension pipe, inlets).

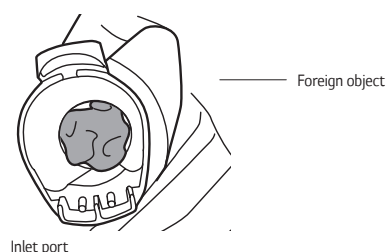
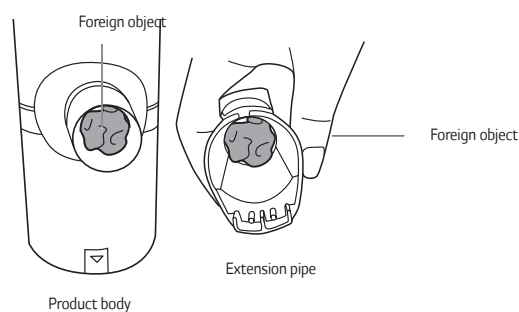

How to use

Cleaning floor/carpet inlets

Please clean the floor and carpet inlets as follows:

- 1 Remove the inlet from the product.
- 2 Put the inlet port upside down and turn the rotating brush removal screw counterclockwise.
 - Use a coin or a flat head screwdriver to turn the screw.

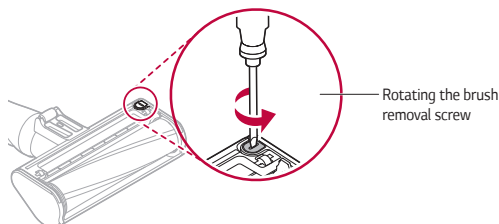

- 3 Pull the brush in the direction of the arrow to remove it.

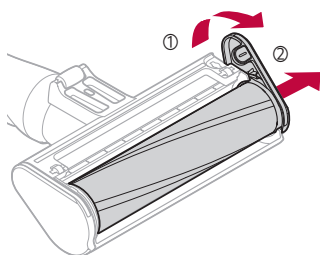

- 4 Attach the blade-shaped inlet to the body and remove dust/foreign object from the brush and the bottom of the inlet <?>.

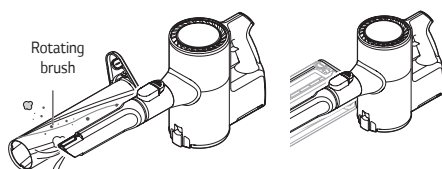

- 5 Use wet towel or tissue to move any remaining foreign object and dust from the brush and the bottom of the inlet port.

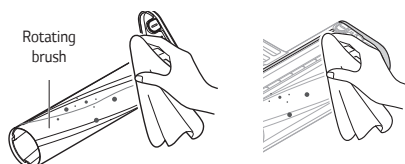

- 6 Assemble the brush in reverse order after cleaning.

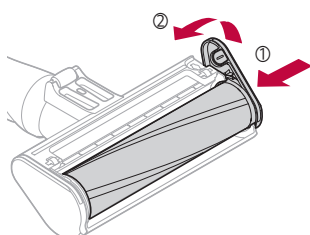

⚠ Care

- Avoid getting your finger stuck in a gap.
- Do not wash the rotating brush and the inlet port with water.
- Do not use the rotating brush as a mop.
- Do not use the inlet port to absorb any liquid.

Cleaning the bedclothes inlet

- 1 Remove the inlet and put it upside down.
- 2 Attach the blade-shaped inlet to the body and remove dust/foreign object from the bottom of the inlet <?>.

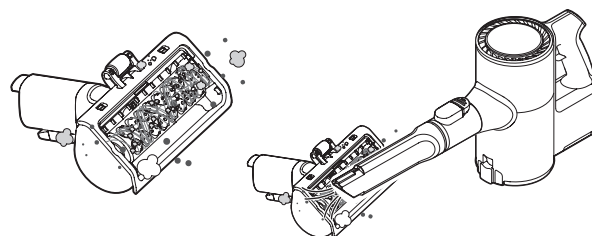

- 3 Use wet towel or tissue to move any remaining foreign object and dust.

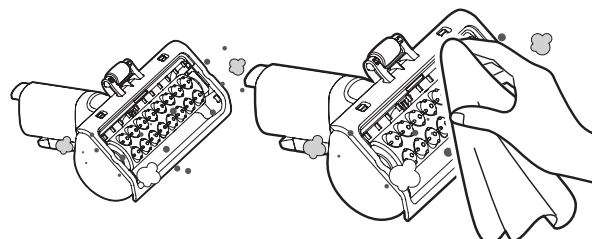

⚠ Warning

- Do not wash the inlet port with water.
- Do not suck in any liquid including water with the inlet port.

Disassembly, assembly and repairing of main parts

Cautions for disassembling

- Make sure to remove the batteries before disassembling the product.
- 1. Most parts are screwed in or inserted mutually. Please refer to the exploded diagram to disassemble the product in the correct sequence.
- 2. Please refrain from disassembling parts other than main ones. Also there is no need to disassemble the product in more details than the exploded diagram.

How disassemble main parts

1. Replacing the handy part



- (1) Remove the screws on the bottom of the product.



- (2) Push the lever upwards to remove the plate.

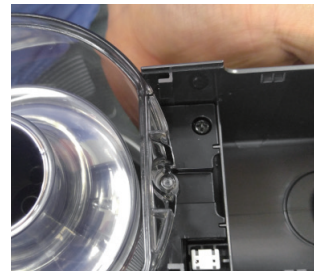

- (3) Remove the screws in the lower part.



- (4) Push and pull the supporter cover as in the figure to remove it.



- (5) Push the handy part as much as you can.

- (6) Reassemble the whole part in the reverse sequence.

Disassembly, assembly and repairing of main parts

2. Replacing main PCB



(1) Disassemble the handy part from the product body.



(2) Remove the button with a knife or a sharp object. Use a thick piece of paper in-between to protect the surface of the part, which will have to be replaced if damaged.



(3) Disassemble Screw in the button.



(4) Hold the bumper with a hand to remove it.



(5) Remove the harness from the handle.



(6) Remove the power PCB with a hand.



(7) Push the main PCB with a hand.



(8) Pull the main PCB with a hand.

(9) Reassemble the whole part in the reverse sequence.

Disassembly, assembly and repairing of main parts

3. How to replace motor assembly

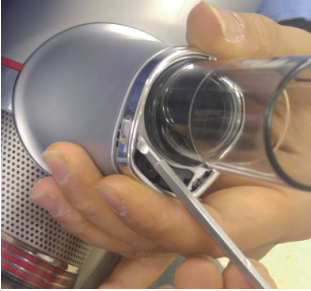

(1) Disassemble the decoration part with a flat head screwdriver.
(It will have to be replaced if damaged)

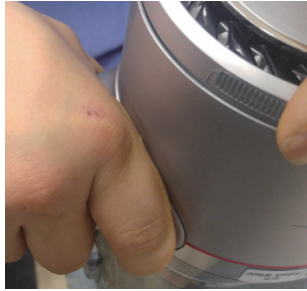

(2) Pull the pipe part with a hand.

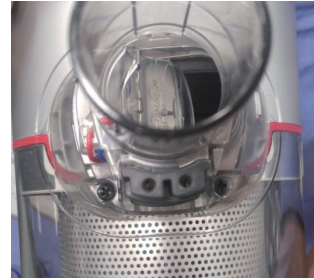

(3) Remove the screws on the bottom of the pipe.

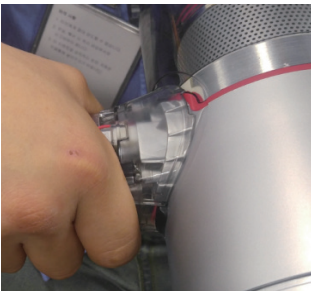

(4) Pull the pipe part with a hand.



(5) Remove the connector from the gasket.

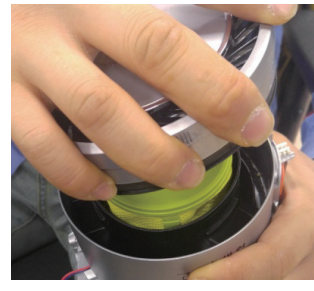

(6) Remove the filter cover and the filter with a hand.



(7) Remove the gasket of the body and the motor, followed by the harness.



(8) Remove the motor from the body.

(9) Reassemble the whole part in the reverse sequence.

※ Note:



Use insulating tape if a gasket is damaged as in the figure while replacing the motor.

Disassembly, assembly and repairing of main parts

4. Disassembling the inlet roller(floor inlet)



(1) Remove the inlet lever with a coin.



(2) Push the left bump up and remove the roller to the left.



(3) Use a long phillips screwdriver to remove the screw in the center.



(4) Refer to the figure for the exact location of the screw.



(5) When the screw is removed, the roller is separated from the bump.

(6) Reassemble the whole part in the reverse sequence.

Disassembly, assembly and repairing of main parts

5. How to disassemble the inlet motor(floor inlet)



(1) Disassemble the inlet roller (Refer to how to disassemble the inletroller in details)



(2) Remove the cover of the right bump with a hand.



(3) Remove 4 screws in the red circle.



(4) Remove the cover below the inlet after removing the 4 screws.



(5) Remove the bump in the figure with a hand.



(6) Remove the top cover of the inlet.



(7) Remove the inlet motor.



(8) Remove the motor harness connector and replace the motor.

(9) Reassemble the whole part in the reverse sequence.

Disassembly, assembly and repairing of main parts

6. Removing charging station PCB



(1) Loosen the 3 screws from the base.



(2) Remove the screw from the groove in the red circle.



(3) Remove the base cover after removing the screw.



(4) Inside of the charging station



(5) Remove the terminals of the charging station.

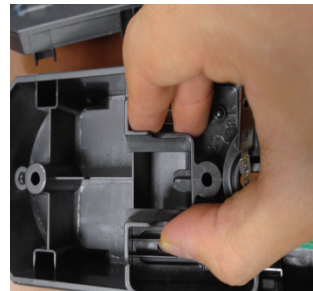

(6) Remove the bump inside the terminals and take out the PCB.



(7) Remove the harness connector and replace the PCB.

(8) Reassemble in the reverse sequence.

Disassembly, assembly and repairing of main parts

7. Disassembling handy decoration assay

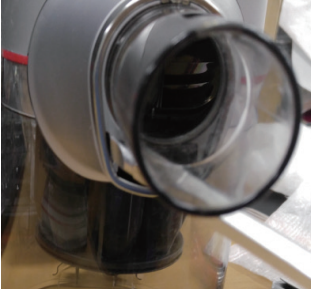

(1) Use a flat headed screw-driver to insert the inner hook and open the gap of the decoration part.



(2) Apply the same method to other parts to open the decoration parts in the figure.

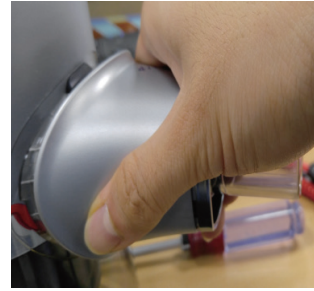

(3) Hold and pull the decoration assay with a hand.

Cautions and what to check for repairing

1. Make sure to remove the batteries first and unplug the charging station when checking or repairing the product.
2. Make sure that no metallic object gets in contact with the charging terminal when checking the current of the circuit.
3. Always use a designated part when replacing it for repair.
4. Always use an appropriate tool when repairing the product..
5. Make sure that the power cord is not damaged before and after repairing the product. If the sheath is damaged or the cord is cut, make sure to repair the part with insulating tape.
6. Make sure to conduct the insulation test of the motor (The value between the part terminals of the motor's impeller cover must be bigger than 5M)

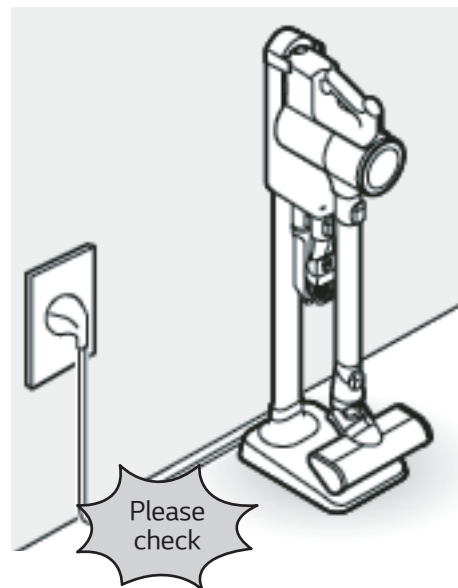
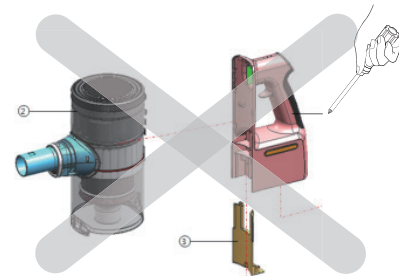
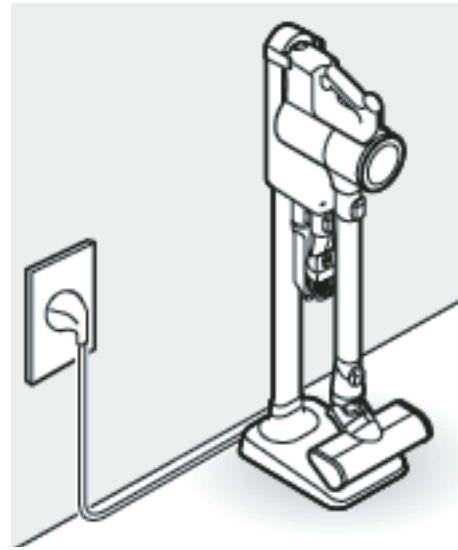

Circuit diagram

• Station PCB

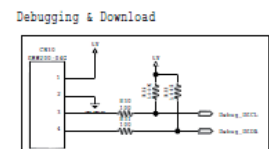
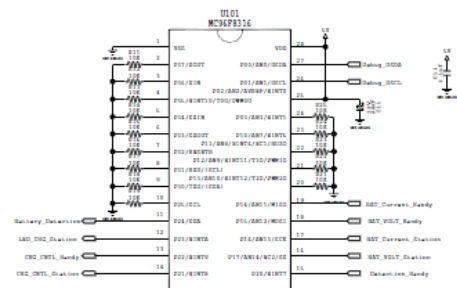
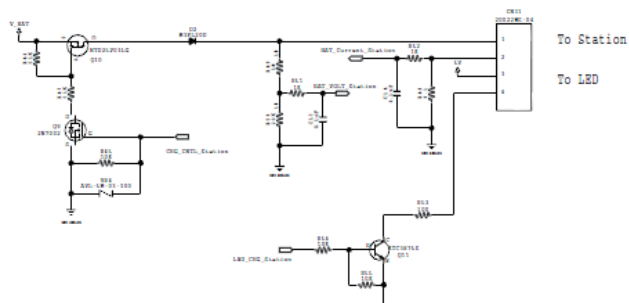
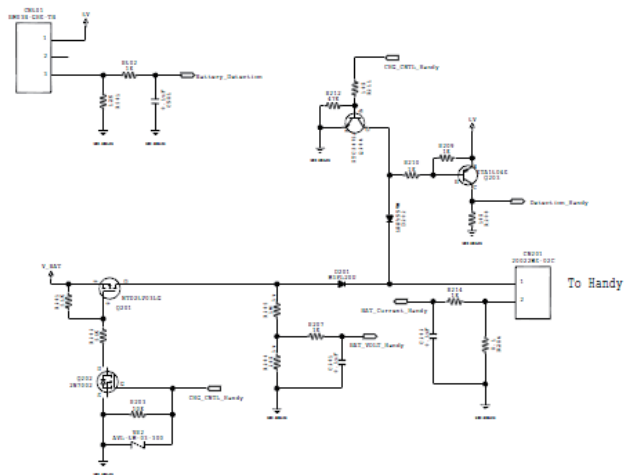
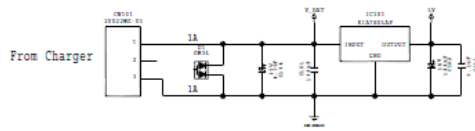

Circuit diagram

• Main PCB(Power)

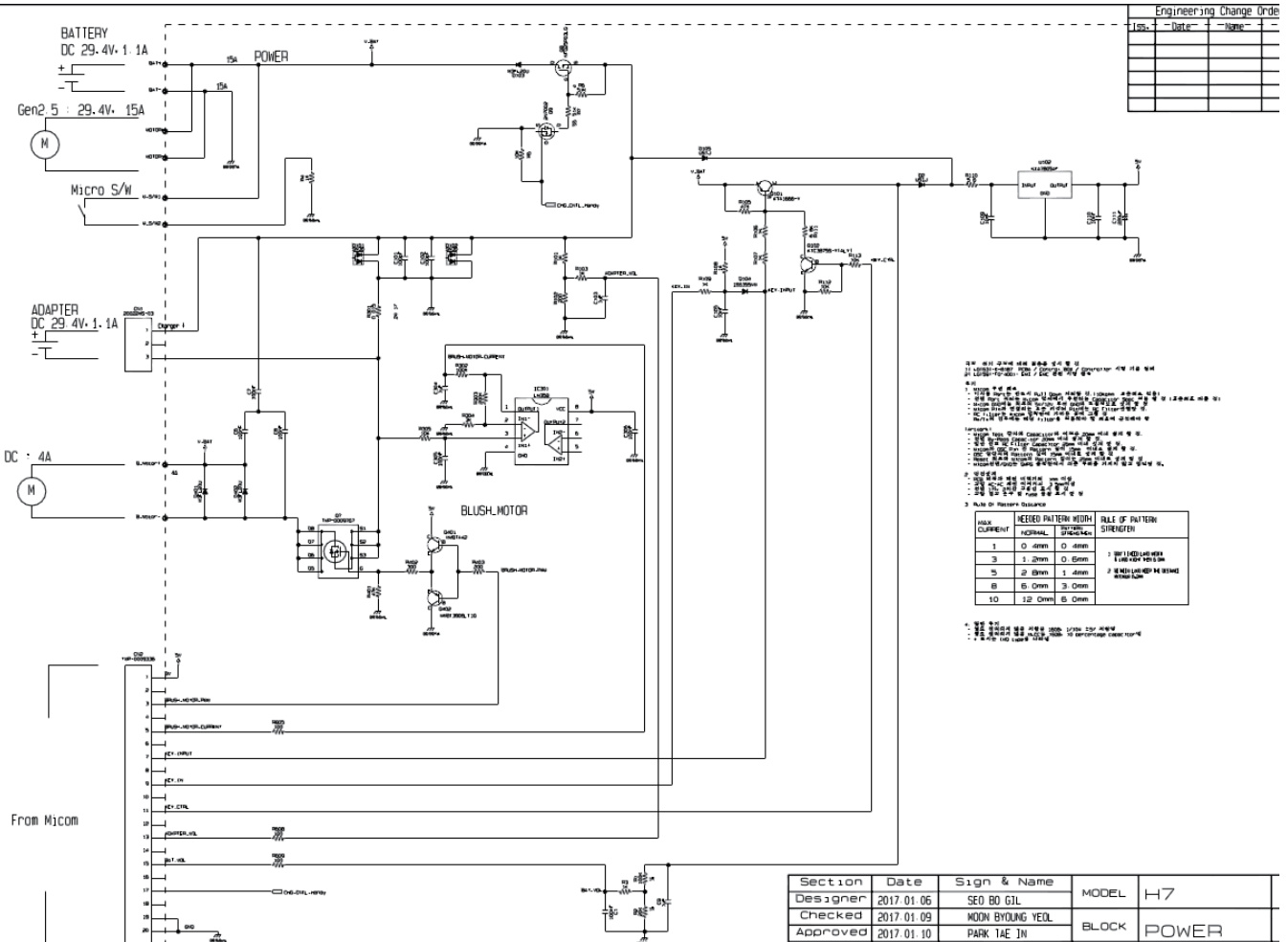

Circuit diagram

• Micom

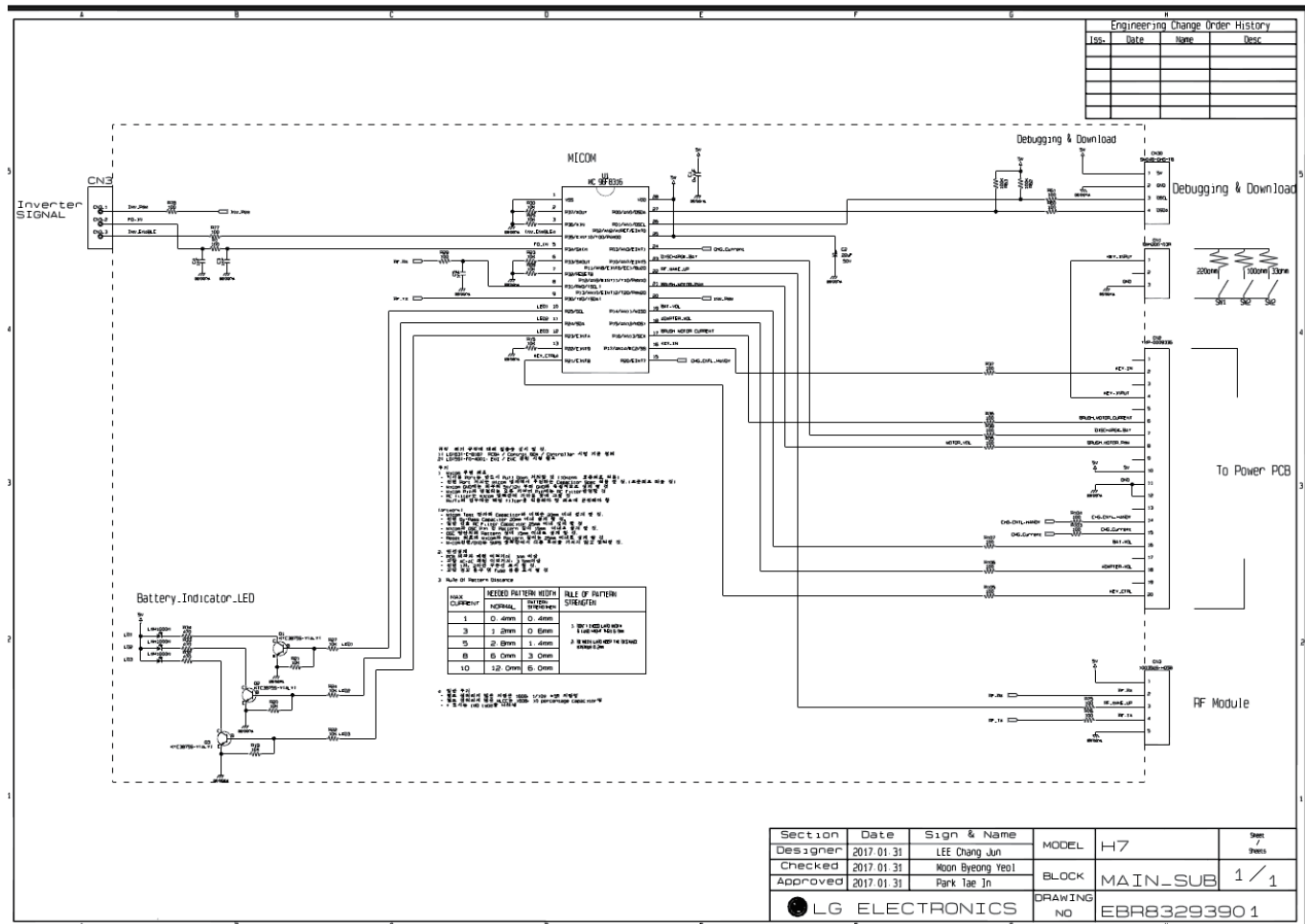

Symptoms of malfunctions and measures

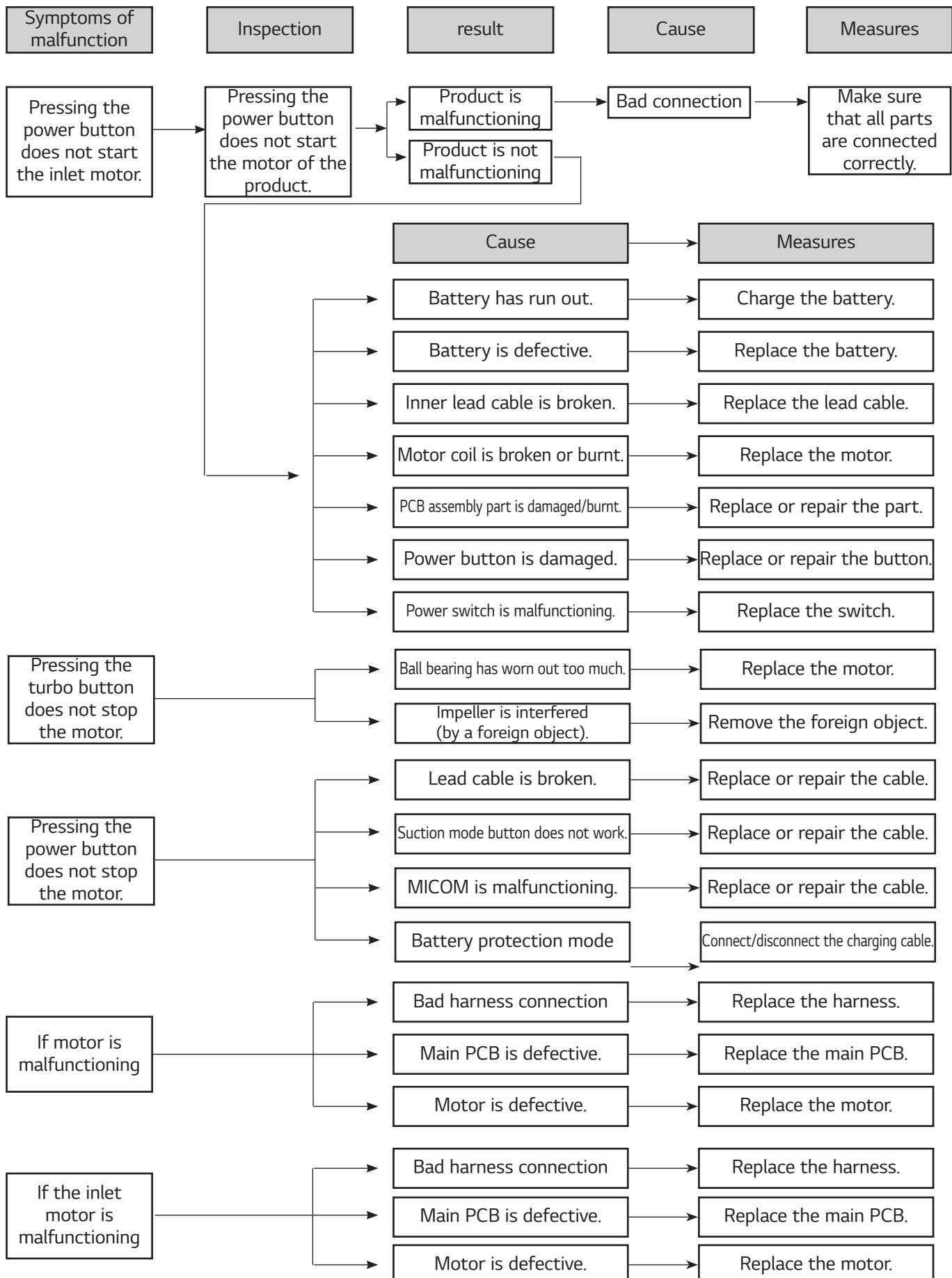

Symptoms of malfunctions and measures

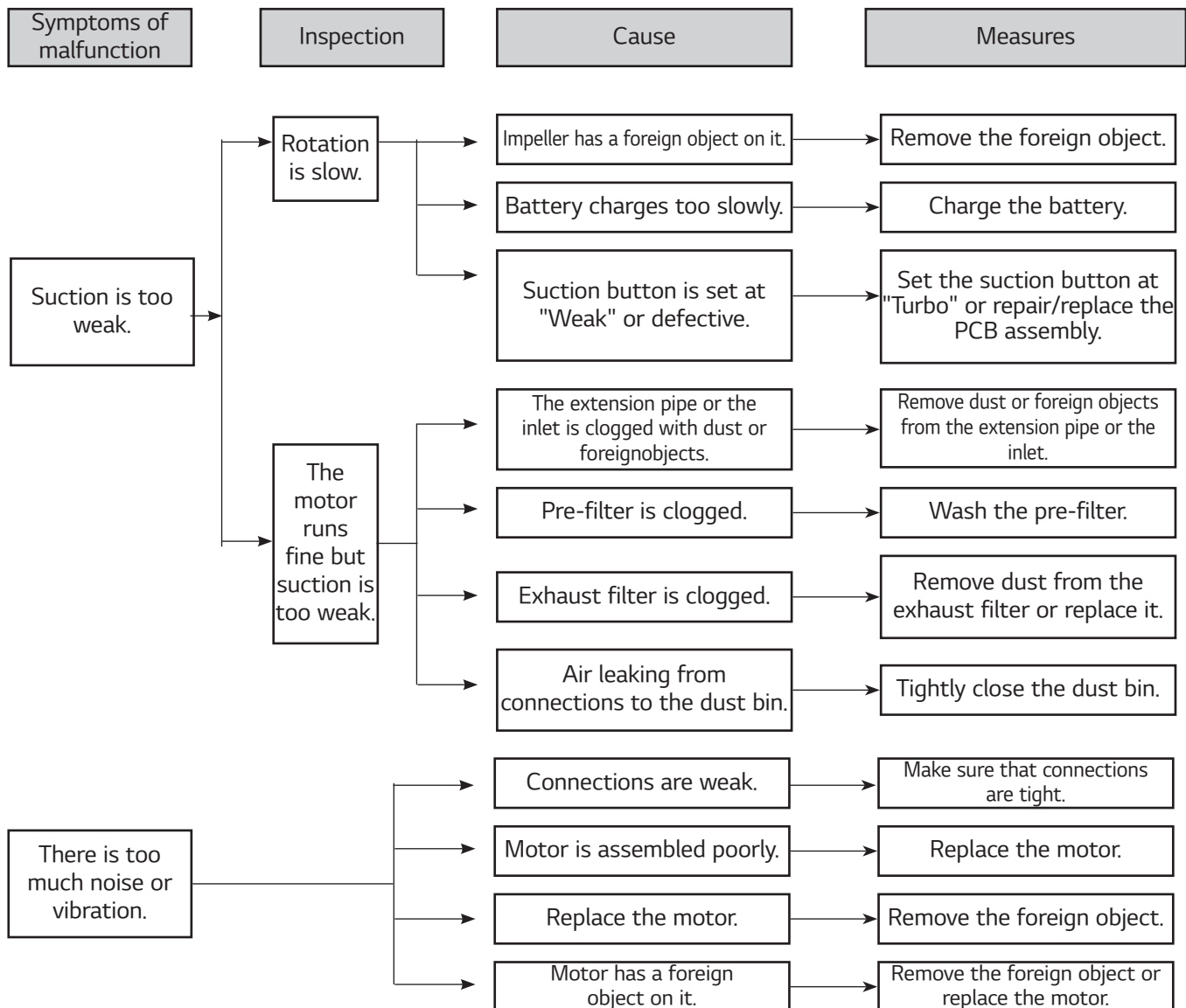

Cleaning functions and error modes

Symptoms	Causes	How to check	Measures
No power engaged (Pressing the power button does not lead to anyfunction)	Main PCB is defective. Battery is defective. Main PCB wire is damaged. Main PCB wire of the handy part is damaged. Connector is poorly assembled. Key PCB of the handy party is defective.	Check if the main PCB has 5V and 12V power. Check if the battery has voltage of $14.5 \pm 0.5V$. Check for any broken part with a tester. Key PCB wire connector of the handy part is poorly assembled. Press the power button of the handy part and check the resistance with a tester.	Replace the main PCB. Replace the battery if the charging station has no defect. Replace the power wire of the product body. Replace the power key wire. Reassemble the key wire connector. Replace the key PCB.
Suction motor is malfunctioning (Battery indicator lights up but the suction motor does not work at all.)	Motor is defective Motor wire is damaged Power connector is poorly assembled. Motor terminal is poorly assembled. Main PCB is defective.	Check if motor coil is damaged with a tester. Check for any broken part with a tester. Check if the connector is properly assembled. Check if the terminals are properly assembled. Check if the triac and resistor are damaged. Check the output voltage of the PCB terminals.	Replace the motor. Replace the motor wire. Reassemble or replace the connector. Reassemble or replace the terminals. Replace the main PCB.
Roller motor is defective. (The suction motor is working but the roller motor does not work in the cleaning mode.)	Motor is defective Motor wire is damaged. Power connector is poorly assembled. Motor terminal is poorly assembled. Motor Poor assembly Main PCB is defective.	Check if motor coil is damaged with a tester. Check for any broken part with a tester. Check if the connector is properly assembled. Check if the terminals are properly assembled. Confirming interference for poor assembly Check if the triac and resistor are damaged. Check the output voltage of the PCB terminals.	Replace the motor. Replace the motor wire. Reassemble or replace the connector. Reassemble or replace the terminals. Reassemble or replace the motor. Replace the main PCB.
Charging station is malfunctioning. (The product does not charge when put into the charging station.)	Station main PCB is defective. Connector is poorly assembled. Check if battery terminals are assembled properly. Station main PCB is defective. Adapter is defective.	Check if input signal voltage is 5V. Check if the connector is properly assembled. Check for any broken part with a tester. Check output voltage from PCB terminals. Check for any broken part with a tester. • If the adapter appears defective, make sure to test it with a measuring device for any output before replacing it. • 29V ~ 29.4V	Station main PCB is defective. Reassemble or replace the connector. Reassemble or replace the battery terminals. Replace the station main PCB. Replace the adapter.

Exploded diagram

VS97*****

© Flufy Nozzle Assembly

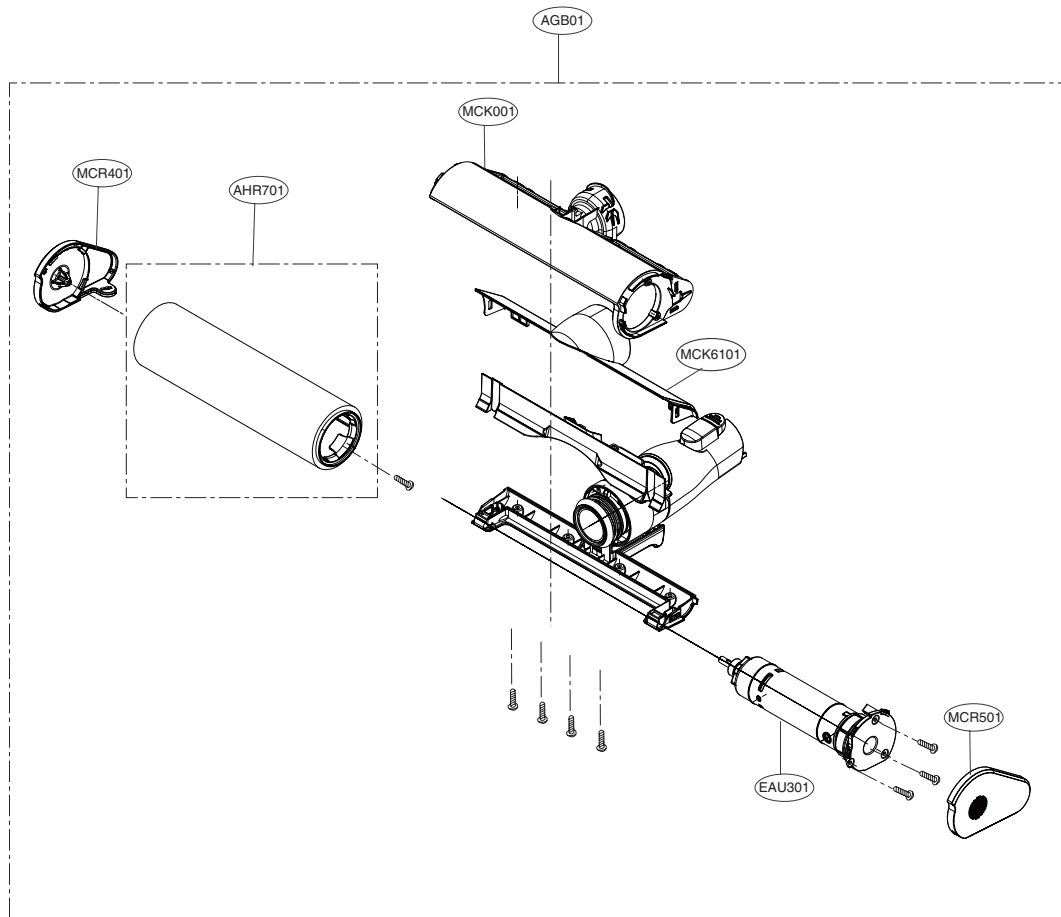

Exploded diagram

VS97*****

© Handle Assembly

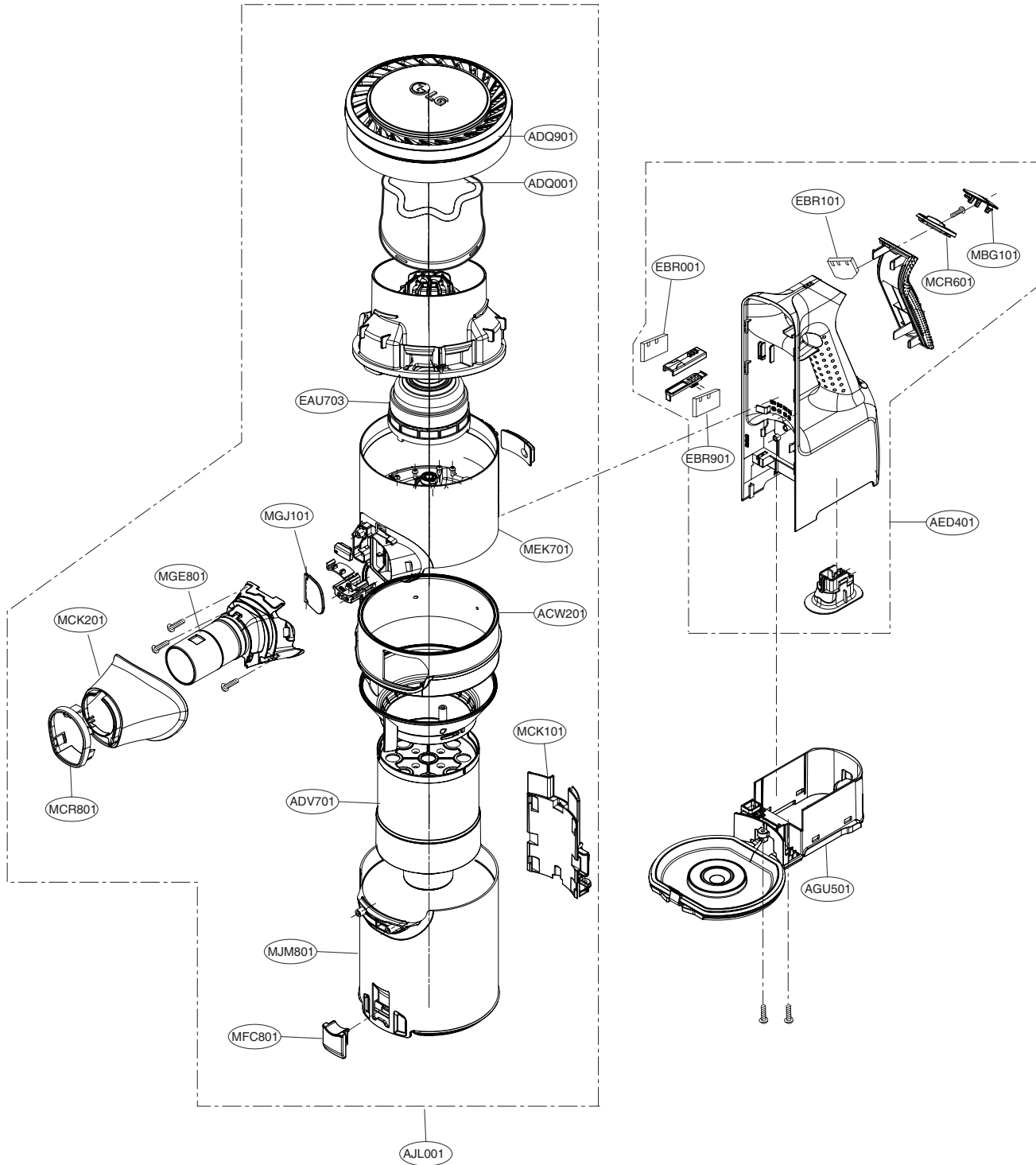

Exploded diagram

VS97*****

© Base Assembly Body

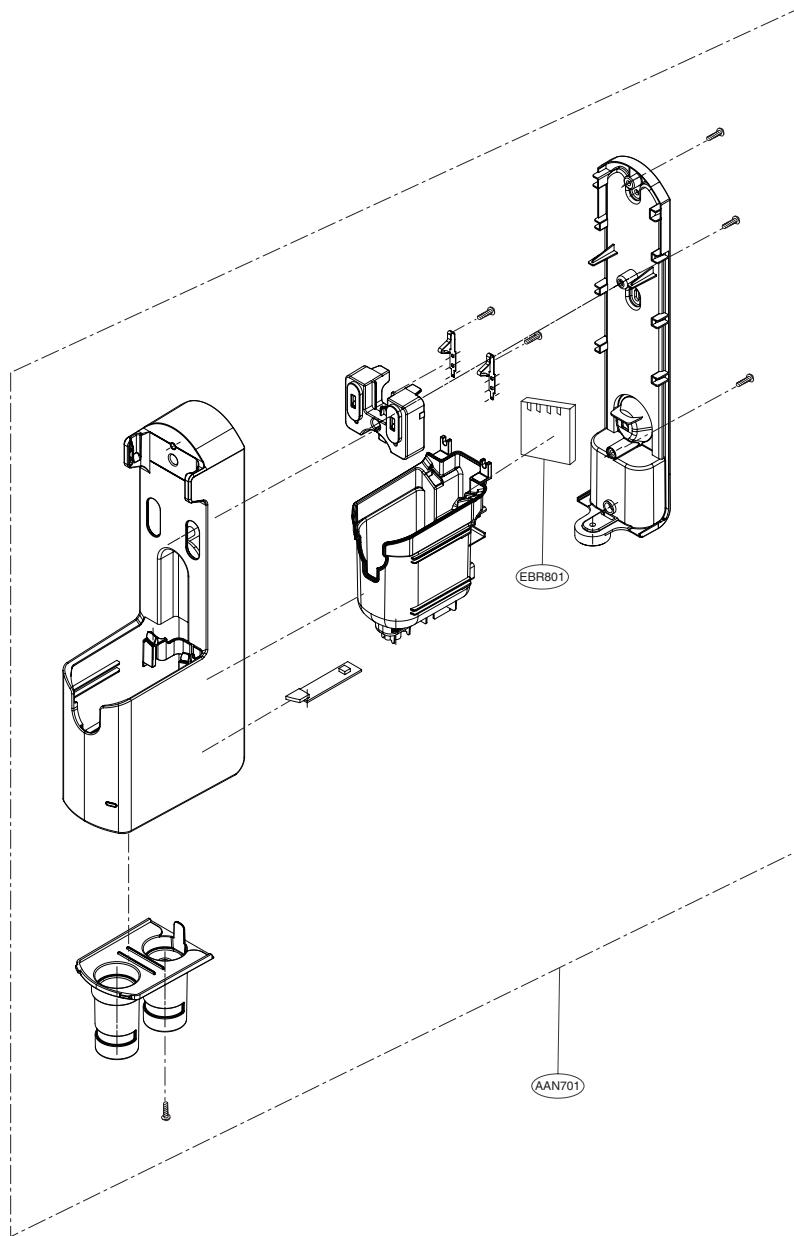

Exploded diagram

VS97*****

© Base Assembly, Lower

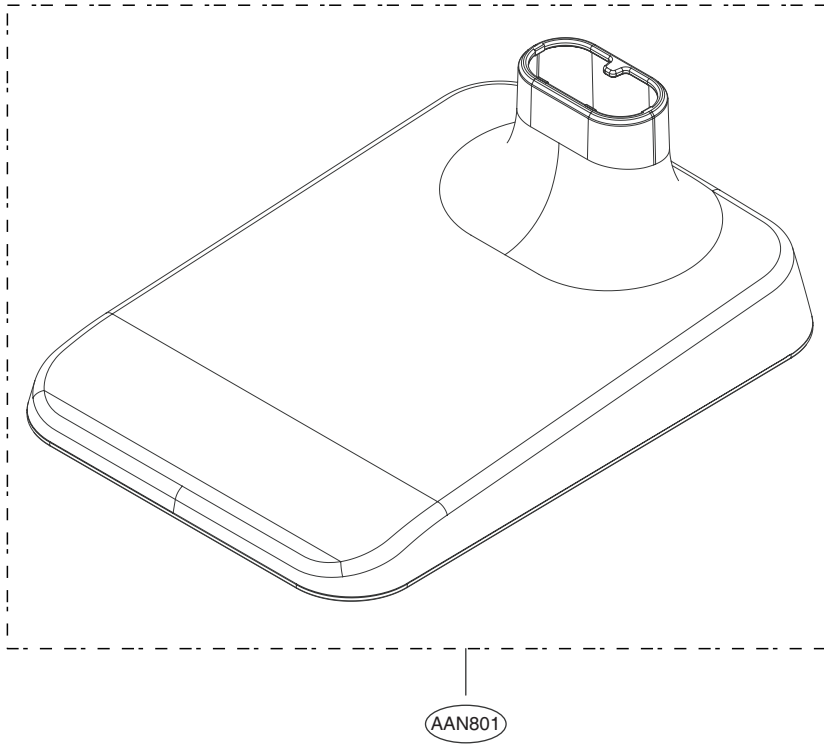

Exploded diagram

VS97*****

© Accessories

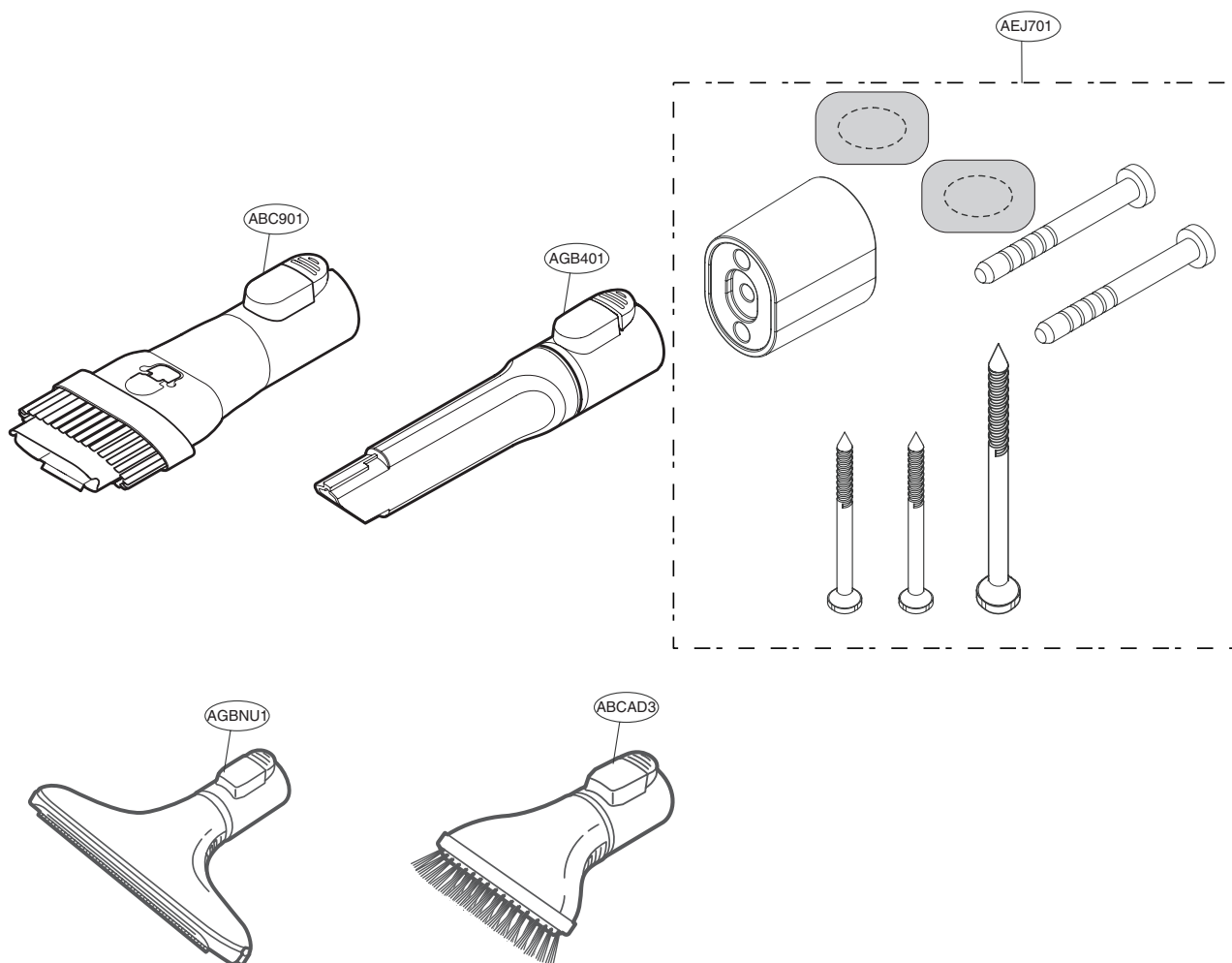

© Pipe Assembly

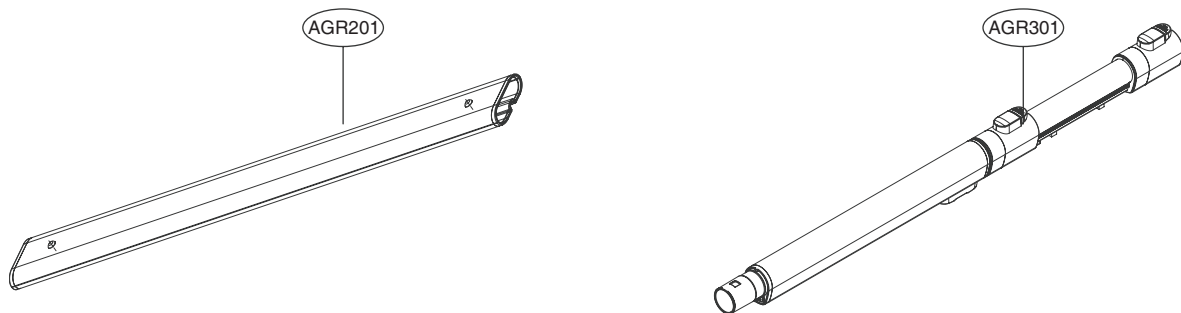

Exploded diagram

VS97*****

© Battery



© Adaptor

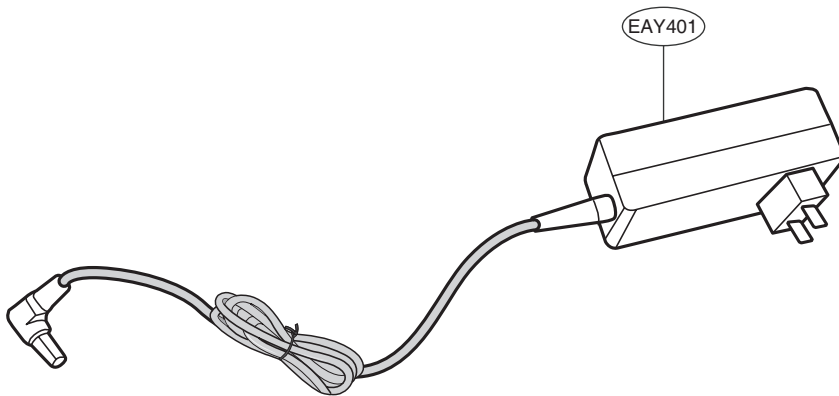

Exploded diagram

VS97*****

© Power Punch Nozzle

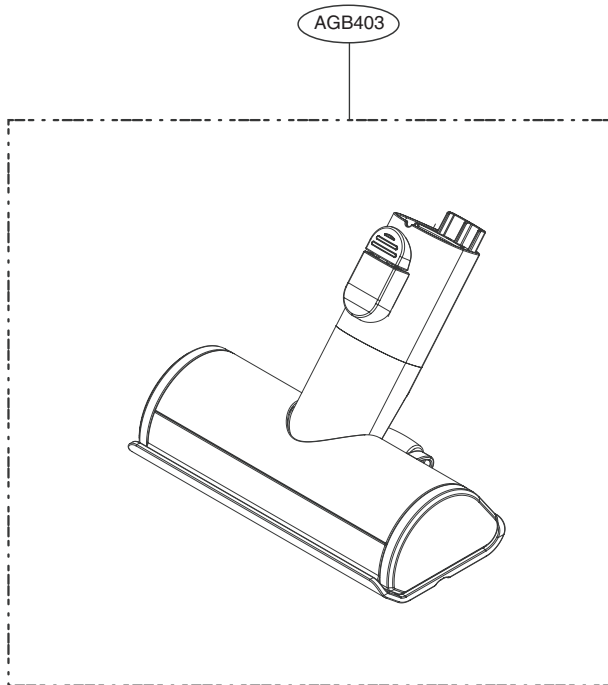

Exploded diagram

VS97*****

© Carpet Nozzle

